

CURB INLET CASTING

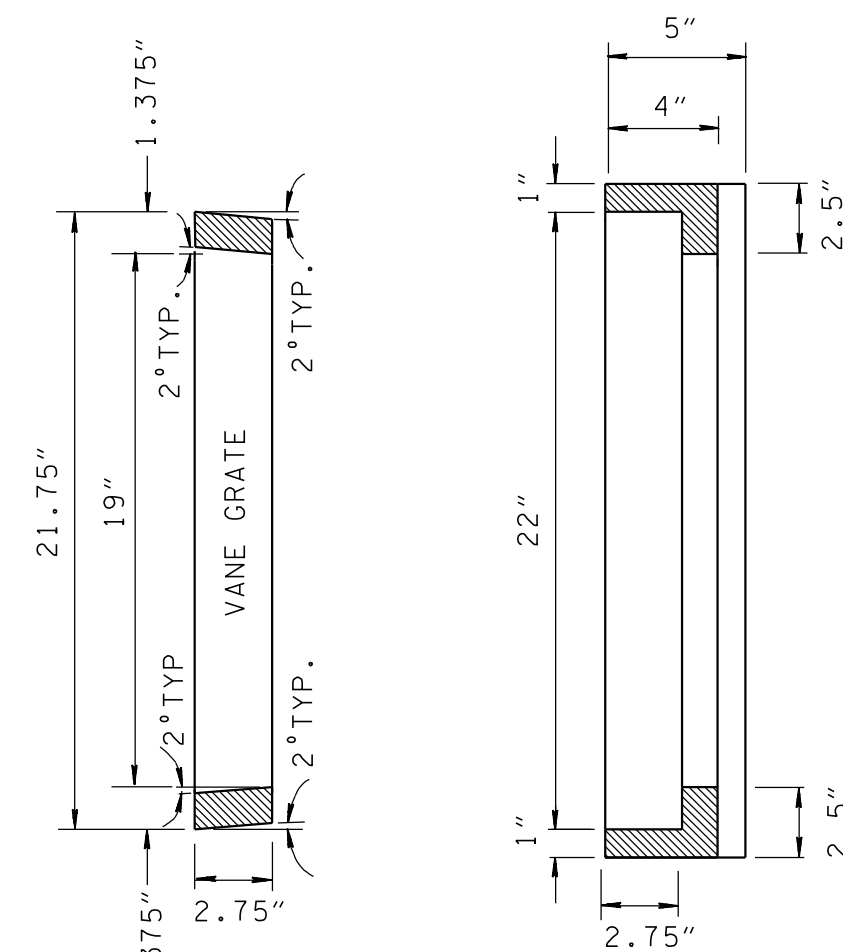

SECTION D-D

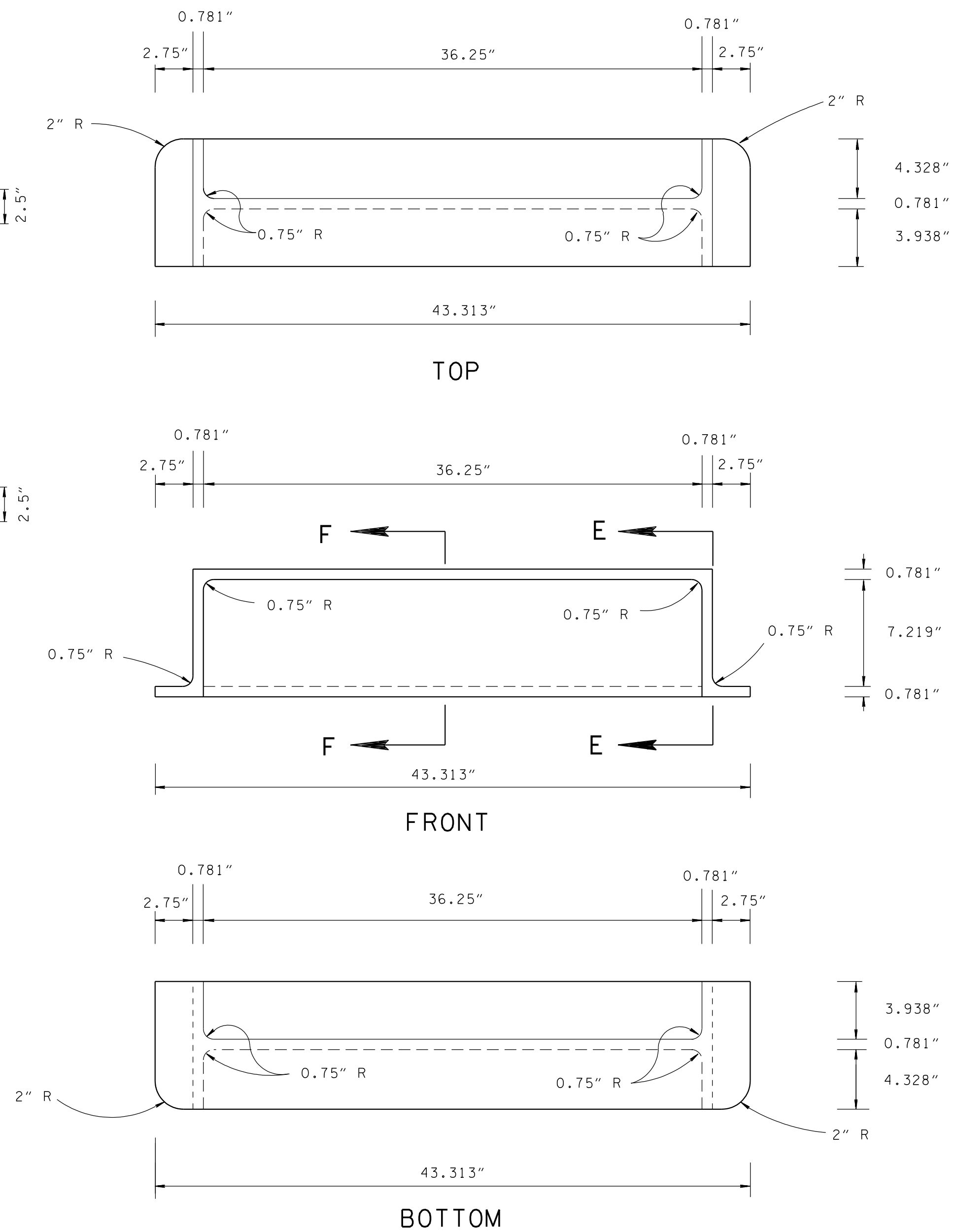

Technical drawing of a bent plate. The drawing shows a cross-section of a plate bent into an L-shape. The dimensions are as follows:

- Top horizontal leg length: 1.766"
- Bottom horizontal leg length: 3.344"
- Vertical leg height: 6.781"
- Bottom horizontal leg thickness: 1.219"
- Bottom horizontal leg width: 0.781"
- Bottom horizontal leg length: 9.047"
- Inner corner radius: 0.75" R

SECTION F-F

(A) WHEN CURB OPENING IN CONCRETE MEDIAN BARRIER WALL IS REQUIRED USE THIS DRAWING ON ALL VARIATIONS OF NUMBER 31, 41, 45, 46, AND 51 CATCH BASINS CONTAINED IN THIS SECTION OF THE STANDARD DRAWINGS.

(B) FOR CLEARNESS, ALL CORNERS ARE SHOWN ON THIS DRAWING BY STRAIGHT LINES WITH THE EXCEPTION OF THE 1" RADIUS AT THE TOP OF FACE OF CURB. ALL INSIDE CORNERS SHOULD BE MADE WITH 1/2" X 1/2" FILLETS OR 3/4" RADIUS FILLETS FOR EASE IN MOULDING.

(C) IF PAID FOR SEPARATELY CAST IRON USED IN CASTINGS IS TO BE PAID FOR UNDER ITEM NO. 611-03.04 GRAY IRON CASTINGS (CATCH BASIN) PER POUND.

(D) IF CATCH BASIN IS PAID FOR UNDER EACH, THEN COST OF CAST IRON USED IN CASTINGS IS TO BE PAID FOR UNDER THE SPECIFIC ITEM BID FOR THAT CATCH BASIN. SEE STANDARD DRAWINGS FOR TYPE 31, 41, 45, 46, AND 51 CATCH BASINS FOR APPLICABLE PAY ITEMS FOR EACH TYPE OF CATCH BASIN.

(SINGLE GRATE CATCH BASIN)

FRAME -----	265 LBS.
GRATE -----	250 LBS.
CURB INLET ----	185 LBS.
<hr/>	
* TOTAL -----	700 LBS.

* NOTE: WEIGHT OF TWO GRATES = 1,400 LBS.

$\frac{3}{64}''$	-	0.047"	$\frac{1}{2}''$	-	0.500"
$\frac{1}{8}''$	-	0.125"	$\frac{5}{8}''$	-	0.625"
$\frac{1}{4}''$	-	0.250"	$1\frac{1}{16}''$	-	0.688"
$\frac{7}{32}''$	-	0.219"	$\frac{3}{4}''$	-	0.750"
$\frac{5}{16}''$	-	0.313"	$4\frac{9}{64}''$	-	0.766"
$2\frac{1}{64}''$	-	0.328"	$2\frac{5}{32}''$	-	0.781"
$1\frac{1}{32}''$	-	0.344"	$\frac{7}{8}''$	-	0.875"
$\frac{3}{8}''$	-	0.375"	$1\frac{5}{16}''$	-	0.938"

TYPE 'B'
CAST IRON FRAME, GRATE
& INLET DETAILS FOR
NOS. 31, 41, 45, 46,
& 51 TYPE CATCH BASINS

1-19-95	D-CBB-31
---------	----------